

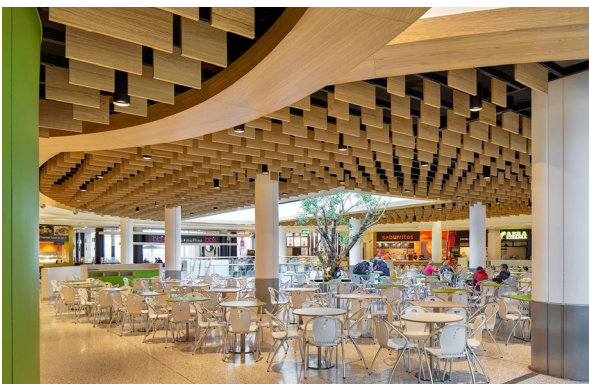

FOODCOURT AREA UPGRADE Liffey Valley Shopping Centre, Dublin



Customer

Liffey Valley Ltd. Savills Ireland
Molesworth Street, Dublin 2

Construction Period

September - November 2014

Design Team

Architect

Henry J Lyons Architects,
51 - 54 Pearse Street, Dublin 2.

Structural Engineers

MMOS Consulting Engineers,
Lane Business Park,
Monaghan Road, Cork

Mechanical & Electrical Consulting Engineers

MMA Environmental,
F3 Riverview Business Park,
Nangor Road, Dublin 12

Project Managers & Cost Consultants

Galbraith & Lawson,
Turnberry House,
175 West George Street,
Glasgow, G2 2LB

DESCRIPTION

The Project extended the seating capacity of the Foodcourt by infilling existing voids over the main Mall whilst the refurbishment works included the installation of new floor and wall finishes, bespoke feature ceilings, new terrazzo floor areas, new furniture to seating areas together with associated mechanical, electrical and sprinkler installations.

All works were completed by Vision Contracting Ltd. at night so that the daily operations of the Foodcourt were not impact by construction works. This involved a high level of site co-ordination with Centre Management.

KEY FEATURES

- Bespoke timber ceiling consisting of hanging lacquered oak fins & intersecting oak veneered rings all secret fixed to secondary structural steel elements fixed back to the main primary steel structure.
- Supply & installation of a Fig tree imported from Holland as a key central feature to the new Foodcourt layout co-ordinated through Mitchell Landscape Architects.
- All works carried out at night as the Foodcourt operates on a 7 day week basis.
- Extensive services co-ordination so that visual impact from services within the feature ceiling was minimised.
- Control of dust in order to ensure that all Food outlets were able to operate each morning without adverse impact from the works undertaken during the night before.